

NOTE:
 (M) Denotes-Install Standard Co. monument Box.

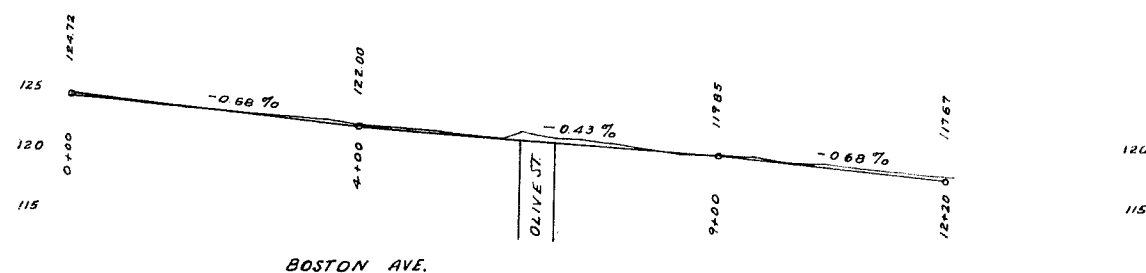
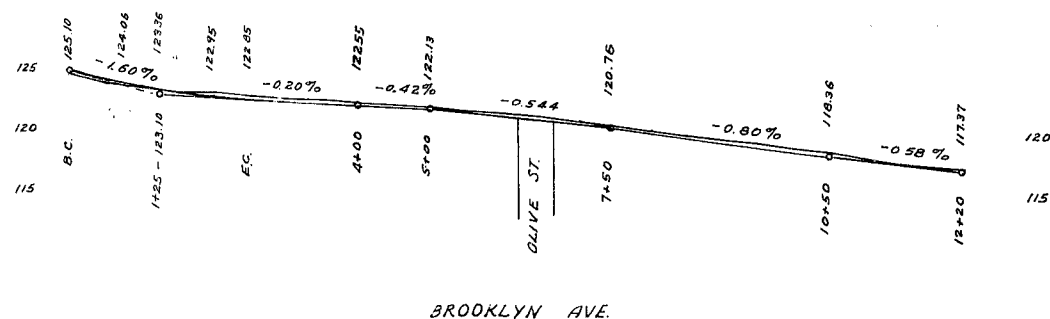

BROOKLYN AVE.

BOSTON AVE.

5 6 7 8 9 10 11 12

0 1 2 3 4 5 6 7 8 9 10 11 12

MICROFILM

3338
 BROOKLYN & BOSTON STS
 Sheet No. of Sheets

LASWELL AVE.

Legend:
 - - - - - Street
 - - - - - Left sidewalk
 - - - - - Right sidewalk
 - - - - - Right of way
 - - - - - Walk to house

VAUGHN AVE.

Legend same as above.

ARLETTA AVE.

RAYMOND AVE.

IRVING AVE.

LELAND AVE.

RUTLAND AVE.

EIGHT STREETS IN BURBANK

Showing Existing Walks and Curbs
 as of July 1st, 1942

T. 107 - p. 22 to 28
 L. 154 - p. 15 to 103
 L. 155 - p. 24 to 70
 Layout No. 3544 - Scott St. (Imp.)
 and Street, between Raymond

Handwritten:
 Profile sheet in Burbank
 showing existing walks and curbs
 as of July 1st, 1942

PROFILE AND GRADES
 FOR
 EIGHT STREETS IN BURBANK
 Showing Existing Walks and Curbs
 as of July 1st, 1942.

ELLIOT ST.
 LASWELL AVE.
 VAUGHN AVE.
 ARLETTA AVE.
 RAYMOND AVE.
 IRVING AVE.
 LELAND AVE.
 RUTLAND AVE.

MICROFILM

Sheet No. 1 of 3 sheets.

3338

LASWELL AVE.

VAUGHN AVE.

ARLETTA AVE.

RAYMOND AVE.

IRVING AVE.

LELAND AVE.

RUTLAND AVE.

ELLIOT ST.

Curb grades.

STREET STREETS IN BURBANK

Showing Existing Walks and Cuts

as of July 1st 1942

T. 117-1122-1-38.

L. 124-1125-1-103.

L. 124-1124-1-70.

L. 124-1123-1-40.

L. 124-1122-1-38.

L. 124-1121-1-26.

L. 124-1120-1-14.

L. 124-1119-1-2.

L. 124-1118-1-1.

L. 124-1117-1-1.

L. 124-1116-1-1.

L. 124-1115-1-1.

MICROFILM 3338

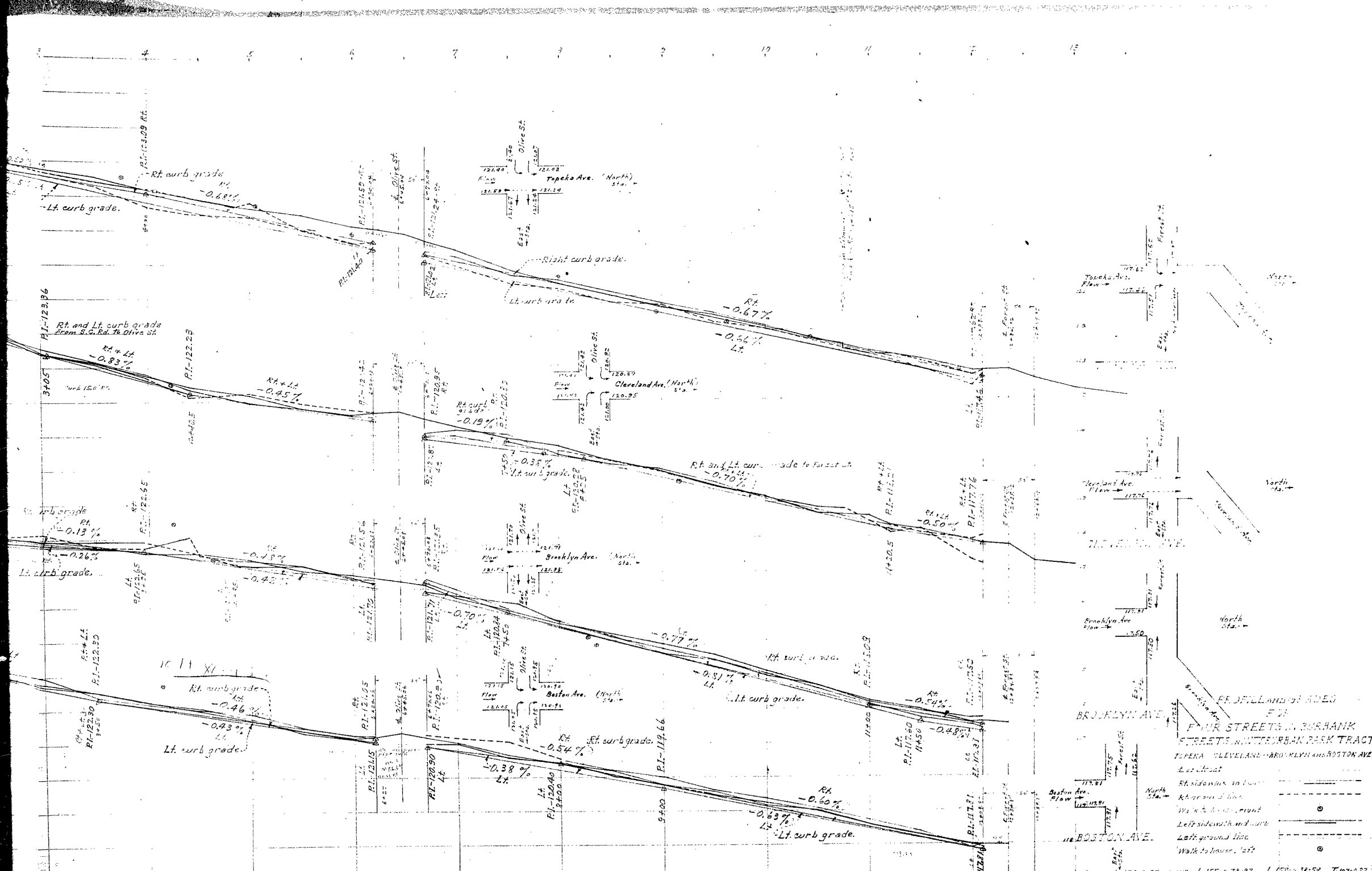

PROPOSED GRADES
FOR
FOUR STREETS IN DUBANK
STREETS IN DUBANK TRACT
TOPEKA CLEVELAND BROOKLYN AND BOSTON AVES.
East street
Rt. sidewalk on left
Rt. ground line
Walk to house, right
Left sidewalk and curb
Left ground line
Walk to house, left